

注：标注 请重点确认

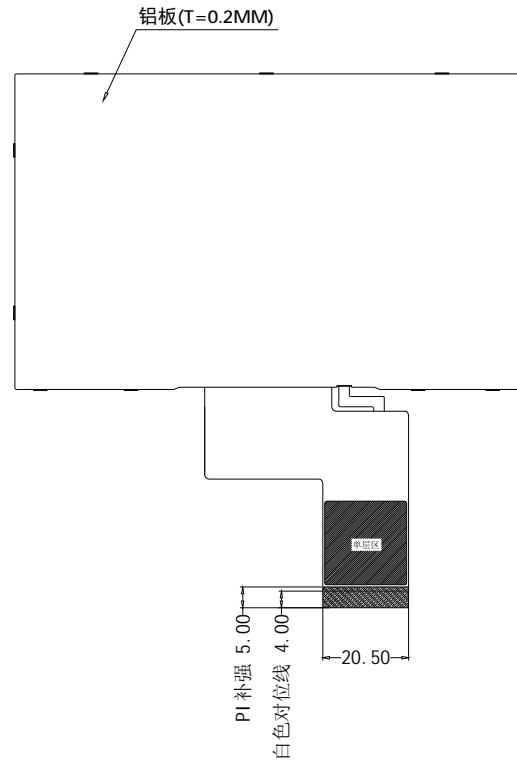
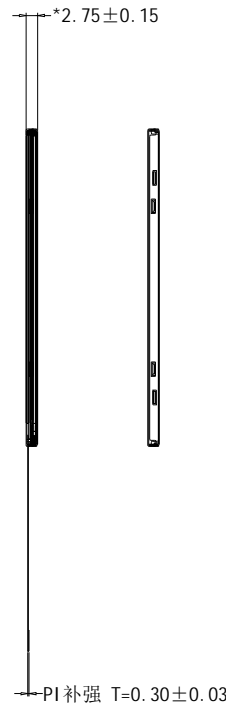
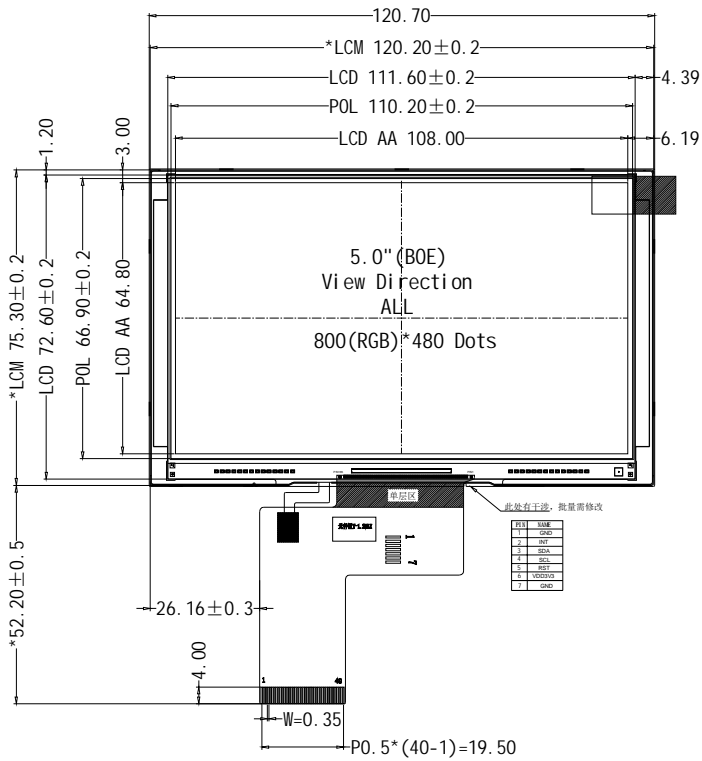

此板有干涉，批量需修改

层号	名称
1	GND
2	OUT
3	DATA
4	RES1
5	RES2
6	VSYNC
7	GND

电路图
CIRCUIT DIAGRAM (LED 6*2=12 dies)

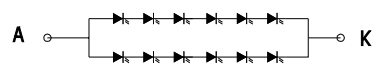

- NOTES:
1. DISPLAY TYPE: 5.0 INCH TFT /TRANSMISSIVE
 2. BACKLIGHT: 12 CHIP WHITE LED, IN PARALLEL
 3. OPERATING TEMP: -20° C~+70° C
 4. STORAGE TEMP: -30° c~+80° c
 5. RESOLUTION: 800(RGB)x480
 6. LCD IC: ST7262
 7. LCM+TP Typical Lumiance: 260cd/m2(TYP)
 8. "()"reference dimension. "*"critical dimension
 9. RoHs Compliant

1	LED-
2	LED+
3	GND
4	VCC
5	RO
6	R1
7	R2
8	R3
9	R4
10	R5
11	R6
12	R7
13	G0
14	G1
15	G2
16	G3
17	G4
18	G5
19	G6
20	G7
21	B0
22	B1
23	B2
24	B3
25	B4
26	B5
27	B6
28	B7
29	GND
30	DCLK
31	DISP
32	HSYNC
33	VSYNC
34	DE
35	TP-INT
36	TP-SDA
37	TP-SCL
38	TP-RST
39	TP-VDD3V3
40	TP-GND

REV	SIGN	DESCRIPTION	PIC	DATE
		修改排线与铁框干涉	KZH	2022.12.12
B		FPC加长3mm	XW	2022.5.14
A		首次发行	XW	2022.5.6

PART DESCRIPTION		LCM		HUA XIAN JING Display Limited www.huaxianjing.com				
DESIGNED				UNIT mm	SCALE 1.00	3rd ANGLE	SIZE A4	SHEET NUMBER 1 of 1
CHECKED				PART NUMBER				DRAWING REV. A
APPROVED				MODEL NAME TFT050B016				PART NUMBER VER. N/A